

# Explosion-Protected Floodlight for Lamps up to 500W Series d3000...

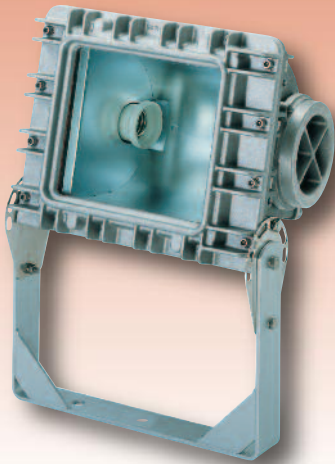

## Applications:

Hazardous locations of zones 1, 2 and 21, 22, on- and offshore installations, loading stations, oil rigs, silos etc.

## Design:

### Housing and glass retaining frame:

From weathering resistant cast aluminium. Lateral lockable screw cap for lamp replacement. Ballast and ignitor inside the housing.

**Condenser box:** Mounted to the back of the floodlight.

**Reflector:** Made from surface refined purest aluminium.

**Glass pane:** Tempered safety glass resistant to temperature variations, glued into the frame.

### Connection terminals:

Standard: L1+N+PE - 2,5mm<sup>2</sup>, in case of compensated version 6mm<sup>2</sup>

### Cable entries:

2 entries M25 x 1,5 (1 plastic gland + 1 plug)

**Mounting position:** Lamp orientation horizontal.

**Mechanical installation:** 1 steel bracket.

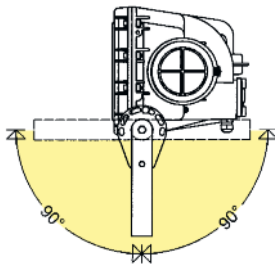
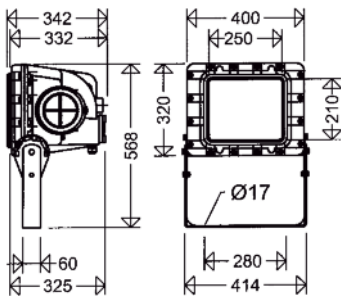

Swivel range: ± 90°

## SCHUCH Quality - your advantage:

- **robust industrial design for reliable and safe long-term use**
  - sturdy and corrosion-resistant housing made of cast aluminium
  - all outer screws and bolts made of stainless steel
  - solid, shock and temperature resistant safety glass pane
- **easy to install and to maintain**
  - easy installation and lamp replacement through screw cap
  - continuously adjustable tilt angle
- **for applications in different ambient conditions**
  - for various lamp types (metal halide-, sodium discharge-, mercury vapour-, halogen lamps)
  - for lamps from: 50W to 500W
  - for 120V, 220V, 230V, 240V and 255V
  - **ATEX**-certified for gas and dust hazardous areas (Zones 1,21 and 2,22) and explosion group II C
  - wide range of admissible ambient temperatures -20°C up to +55°C

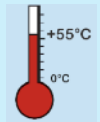

## d3000...



II 2 G Ex db eb IIC T4,T3,T2

II 2 D Ex tb IIIC T100-240°C

IP66/67



### EC-Type Examination Certificate:

PTB10 ATEX 1002X

### Marking:

II 2 G Ex de IIC T4,T3,T2 (Zone 1)

II 2 D Ex tb A21 IIIC T100-240°C (Zone 21)

Ignition protection: d (flameproof)

### Admissible ambient temperature:

-20°C up to +40°C / +55°C

### Rated voltage:

Standard:

230V, 50 Hz,

220V or 240V, 50/60Hz.

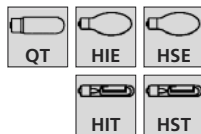

Type	Article no.	Temp. class	Lamps Watt	Weight ca.kg <sup>5)</sup>
------	-------------	-------------	------------	----------------------------

### for tungsten halogen lamps up to 500W, socket E40 or E27

d3000/250 QT <sup>4)</sup>	30001 0001	T3	1 x QT32 250 W	25,0
d3000/500 QT <sup>3)</sup>	30001 0002	T2	1 x QT38 500 W <sup>2)</sup>	25,0

### for high pressure discharge lamps, socket E40 or E27

d3000/70 HS <sup>4)</sup>	30001 0013 <sup>1)</sup>	T4	1 x HSE/HST 70	24,2
d3000/150 HIE E27 <sup>4)</sup>	30001 0011 <sup>1)</sup>	T4	1 x HIE-CE/HIE 150	27,5
d3000/150 HI/HS E40 <sup>3)</sup>	30001 0007 <sup>1)</sup>	T4	1 x HIT/HSE/HST 150 1 x HIT-CE 150	27,3
d3000/250 HI/HS <sup>3)</sup>	30001 0009 <sup>1)</sup>	T3	1 x HIE/HIT/HSE/HST 250 1 x HIT-CE 250	28,8

1) Uncomp., article no. for comp. (with condenser box m4015) see price list.

2) PHILIPS IDE

3) Socket E40

4) Socket E27

5) Weights without packing material

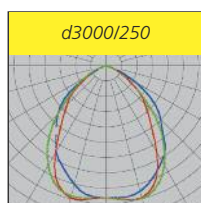
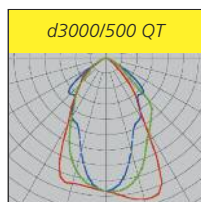

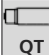
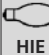





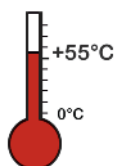

Photo: BASF

**d3000... H..**  II 2 G Ex db eb IIC T4,T3,T2 II 2 D Ex tb IIIC T100-240°C IP66/67 

for high ambient temperatures up to +55°C

	Type	Article no.	Temp.-class	Lamps Watt	Weight ca. kg <sup>6)</sup>
					
					
	<b>for tungsten halogen lamps, socket E40 or E27</b>				
	d3000/250 QT H55 <sup>5)</sup>	30001 0101	T3	1 x QT32 250 W	25,0
	d3000/500 QT H50 <sup>4)</sup>	30001 0102	T2	1 x QT38 500 W <sup>3)</sup>	25,0
	<b>for high pressure lamps, socket E40 or E27</b>				
	d3000/150 HV/HS E40 H55 <sup>2) 4)</sup>	30001 0107 <sup>1)</sup>	T3	1 x HIT/HSE/HST 150	27,3
	d3000/150 HIE E27 H55 <sup>2) 5)</sup>	30001 0111 <sup>1)</sup>	T3	1 x HIE-CE/HIE 150	27,5



1) Uncomp., article no. for comp. see price list  
2) Only such metal halide lamps may be used which are allowed to be operated with hpsv ballasts.

3) PHILIPS IDE  
4) Socket E40  
5) Socket E27  
6) Weights without packing material.

## ! Further Series / Equipment

- hard-coating for very aggressive ambient conditions
  - with bracket from stainless steel
  - different cable glands
  - 2<sup>nd</sup> cable gland for mains cable looping
  - in 120V version for 300W, 500W
- (QT lamp JTT of brand Eye)  
- with terminals up to 6mm<sup>2</sup> in case of uncomp. version

## Accessories / Spare Parts

Type	Article no.	
<b>Cable entries / Cable glands</b>		
2537	90117 9000	Ex-protected plastic cable gland M25 x 1,5
2538	90118 9000	Ex-protected plastic plug M25 x 1,5
<b>Cable entries / Cable glands for d3000/500 QT H55 and HS</b>		
2537 MS	90117 9001	Ex-protected brass cable gland M25 x 1,5
2594	90118 9002	Ex-protected brass plug M25 x 1,5