



## Explosion-Protected Light Fitting for lamps up to 250 W Series d6300...

### Applications:

Hazardous locations of zones 1 and 2; 21 and 22 high installations in tank stations etc.

### Design:

**Housing and glass retaining ring:**  
From weather resistant cast aluminium, powder coated in light grey (RAL 7035), with hinged glass retaining ring with locking bolt, roller ring gasket; ballast, condenser and if necessary ignitor are located in the upper section of the housing

**Globe:** Thermal glass located in the glass retaining ring.

**Connection terminals:** Standard: L1+N+PE max. up to 2,5mm<sup>2</sup>;

up to 6mm<sup>2</sup> upon request; internal and external connection of earth conductor.

**Cable entries:** 2 entries M25 x 1,5 (1 gland, 1 locking screw).

**Mounting method:** Facing downwards or swivelled up to ± 40° off-centre.

**Mechanical installation:** Variable; accessories please see spare parts / accessories.

### SCHUCH Quality - your advantage

- **robust industrial design for reliable and safe long-term use**
  - sturdy and corrosion-resistant housing made of cast aluminium
  - all outer screws and bolts made of stainless steel
  - solid, shock and temperature resistant safety glass dome
- **easy to install and to maintain**
  - easy installation due to cast on connection box in increased safety
  - easy lamp replacement due to hinged glass retaining ring
- **For applications in different ambient conditions**
  - for various lamp types (metal halide-, sodium discharge-, mercury vapour-, halogen-, blended-, induction- and fluorescent lamps)
  - for lamps from 26W to 250W
  - **ATEX**-certified for gas hazardous areas of zones 1 and 2
  - **ATEX**-certified for explosion group II C up to temperature class T6
  - wide range of admissible ambient temperatures -20°C up to +50°C

T6

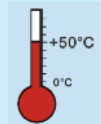

2 Suspension hooks RS 8 Ceiling bracket 62 A

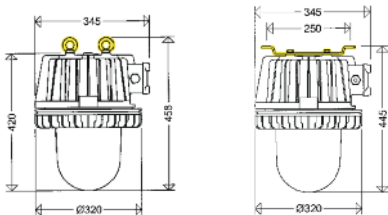

Mounting 63 SWB

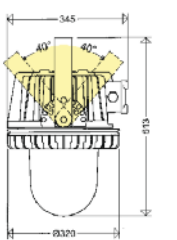

Swivel range ± 40°  
adjustable in steps of 10°

Wall mounting

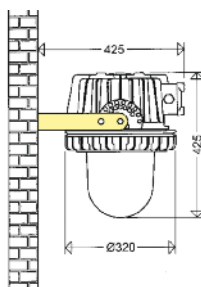

Wire guard SK

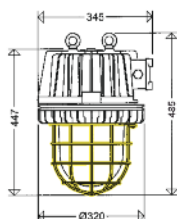

d6300...



II 2 G Ex db eb IIC T6,T4

II 2 D Ex tb IIIC T90-130°C

IP66/67



EC-Type Examination Certificate:

PTB10 ATEX 1003X

Marking:

II 2 G Ex db eb IIC T6,T4 (Zone 1)

II 2 D Ex tb IIIC T90-130°C (Zone 21)

Ignition protection:

d (flameproof encapsulation)

Admissible ambient temperature:

-20°C up to +40°C/+50°C (depending on version)

Rated voltage: KVG: 230 V, 50 Hz (Standard);

ECG: 220-240 V AC/DC, 0 or 50/60 Hz.

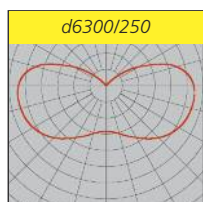
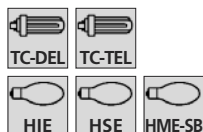

Type	Article no.	Temp. class	Lamps/Watt	Weight ca.kg <sup>3)</sup>
------	-------------	-------------	------------	----------------------------

for compact fluorescent lamps, socket G24q or Gx24q, with electronic ballast (EVG)

d6300/226KL EVG <sup>1)</sup>	63000 0029	T6	2 x TC-DEL 26	11,1
d6300/32KL EVG <sup>1)</sup>	63000 0030	T6	1 x TC-TEL 32	14,5
d6300/42KL EVG <sup>1)</sup>	63000 0031	T6	1 x TC-TEL 42	14,5

for blended lamps, socket E40

d6300/250 ML	63000 0032	T4	1 x HME-SB 250	14,0
--------------	------------	----	----------------	------

for high pressure discharge lamps, socket E27 or E40

d6300/100 HI <sup>1)</sup>	63000 0019 <sup>2)</sup>	T4	1 x HIE 100	16,2
d6300/150 HI	63000 0021 <sup>2)</sup>	T4	1 x HIE 150	12,6
d6300/250 HI	63000 0003 <sup>2)</sup>	T4	1 x HIE 250	17,0
d6300/100 HS <sup>1)</sup>	63000 0023 <sup>2)</sup>	T4	1 x HSE 100	16,2
d6300/150 HS <sup>1)</sup>	63000 0025 <sup>2)</sup>	T4	1 x HSE 150	13,9
d6300/250 HS	63000 0005 <sup>2)</sup>	T4	1 x HSE 250	17,0

1) Admissible ambient temp.: +50°C

3) Weights without packing material

2) Uncomp., article nos. for comp. see price list

# d6300... H50



II 2 G Ex db eb IIC T4

II 2 D Ex tb IIIC T90-130°C

IP66/67



for high ambient temperatures up to +50°C

The types for compact fluorescent lamps as well as for high pressure discharge lamps < 250W as well as for blended

lamps have been certified for +50°C a.t. in their standard version.

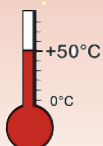

Type	Article no.	Temp.-class	Lamps Watt	Weight ca.kg <sup>3)</sup>
------	-------------	-------------	------------	----------------------------

### for high pressure discharge lamps, socket E27 or E40

d6300/150 HI H50	63000 0027 <sup>1)</sup>	T4	1 x HIE 150	12,6
d6300/250 HI H50	63000 0009 <sup>1)</sup>	T4	1 x HIE 250	17,0
d6300/250 HS H50	63000 0013 <sup>1)</sup>	T4	1 x HSE 250	17,0

1) Uncomp., article nos. for comp. see price list 3) Weights without packing material  
2) with inductive ballast only



Photo: BASF

Explosion protected Light Fittings Zone 1

## Further Series / Equipment

- with connection terminals up to 10mm<sup>2</sup>
- with 2 cable glands
- connection terminals up to 6mm<sup>2</sup> (max. 10.0mm<sup>2</sup>)
- with ex-protected cable glands different from the standard ones
- hard coated version for installation in very aggressive atmospheres (e.g. offshore installations)
- with wire guard
- with external reflector
- with swivel arm
- for blended lamps HME-SB 100-250W

d 6300 with external reflector of high bay and low bay versions

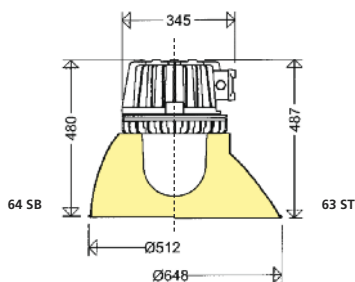

## Accessories / Spare Parts

Type	Article no.	
63 ST	63001 0001	external reflector narrow beam
64 SB	90097 0001	external reflector wide beam
2537	90117 9000	ex-protected plastic cable gland M25 x 1,5 (for d6300/100-250 HI, .../100-150 HS)
2537 MS	90117 9001	ex-protected brass gland M25 x 1,5 (for .../250HI, ... H50, .../250HS, .../125 and .../250)
RS 8 P	90028 0002	1 pair of suspension hooks, galvanized steel, M8
62 A	90010 0001	ceiling bracket, galvanized steel
63 SWB	90246 0001	swivel arm, galvanized steel
63 SK	63002 0001	wire guard